

FOR SALE

COMMERCIAL - LIGHT INDUSTRIAL (B1) 2,454SQFT (228SQM) / CALL FOR PRICE!

+65 9728 9990



Typical Suite

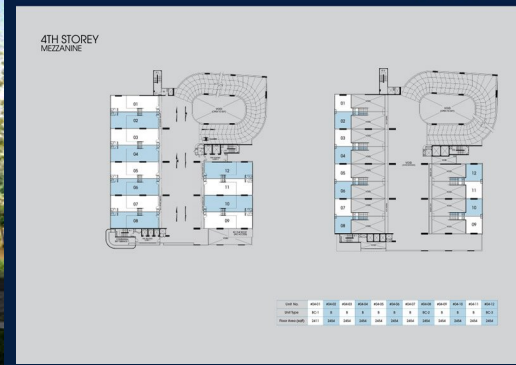

COMMERCIAL - LIGHT INDUSTRIAL (B1) INSPACE, 24, NEW INDUSTRIAL ROAD, HOUGANG, SINGAPORE 536210

- LISTING ID: SGLD23813593
- TENURE: FREEHOLD
- TITLE: N/A
- SIZE BUILT-UP: 2,454SQFT (228SQM)
- SIZE LAND: 1.431AC (0.579HA)
- NO. OF FLOORS: 8
- FLOOR/LEVEL: N/A - N/A
- PARKING SPACES: N/A
- LAYOUT TYPE: OTHER
- FACING: N/A
- VIEWING: OTHER
- SELLING PRICE: **CALL FOR PRICE!**
- COMPLETION YEAR: 2022
- CONDITION: N/A
- LISTING DATE: JUL 04, 2019

INSPACE

EXTERIOR FACILITIES

- 24 Hours Security
- Pool Deck
- Pavilion
- BBQ (Area / Pavilion)

VISIT THIS PROPERTY AT: <https://www.doreenong-realtor.com/property/SGLD23813593>



DOREEN ONG - HUTTONS ASIA PTE LTD

3 Bishan Place #05-01 CPF Bishan Building
D20, 579838, Singapore

+65 9728 9990
WhatsApp Me

doreenong0202@gmail.com

L3008899K
R025450B

<https://www.doreenong-realtor.com>



Scan QR Code

Huttons® Call for Viewing
The Agency of Choice +65-97289990